

SPEED-CONTROLLED, WALL TYPE AXIAL FAN



GMC AXF-606:

Axial wall fan

Application

- Combined supply and extract ventilation systems of premises for different destinations, where a high air flow capacity are required at relatively low resistance of the system
- Application in the motors of ball bearings provides a long servicelife (40 000 hours)
- Can be used for the direct ejection of the exhaust air or static suction head ventilation in fire-prevention ventilation systems
- Air flow direction: from impeller to motor (rotation direction cannot be changed)
- Installation: built-in all directions

Composition

- The fan case and the impeller are made of steel body with polymeric covering
- Terminal box has a cord for remote connecting
- Two- and four-pole of one- or three-phase asynchronous motors equipped with built-in thermal protection on automatic restart are used
- Class of motor protection is IP 44
- Speed controllable

Options

- Motor options:
- 2 = 2 Poles
- 4 = 4 Poles
- M = one phase
- T = three phase

Accessories

- Speed controller type **STL**, **MTY** and **BTRN**
- Backdraught shutters **VK**
- Safety guard **BSV**



SPEED-CONTROLLED, WALL TYPE AXIAL FAN



Order example

- AXF-606: Mk.300 4M + MTY1
- **Mk.300** = flange diameter
- **4** = 4 poles
- **M** = one phase, **T** = three phases
- **MTY** = speed controller

Air Performance Data

Model		Qv [m ³ /h]						
		0 Pa	25 Pa	50 Pa	75 Pa	100 Pa	150 Pa	200 Pa
Mk.	200 2M	850	730	650	450	-	-	-
	250 2M	1050	900	750	620	500	-	-
	250 4M	800	600	350	-	-	-	-
	300 2M	2250	1900	1750	1450	1000	-	-
	300 4M	1350	1200	1000	700	-	-	-
	350 4M	2500	2200	1850	1500	1250	-	-
	400 4M	3600	3200	2700	2000	1200	-	-
	450 4M	4600	4400	4000	3800	2650	-	-
	500 4M	7000	6200	5500	5000	4000	-	-
	550 4M	8800	8000	7000	6000	5000	-	-
630 4M	12000	11000	10000	9000	8000	6000	4000	
Model		Qv [m ³ /h]						
		0 Pa	25 Pa	50 Pa	75 Pa	100 Pa	150 Pa	200 Pa
Mk.	250 2T	1100	975	800	650	500	-	-
	250 4T	850	675	400	-	-	-	-
	300 2T	2275	2050	1750	1500	1250	-	-
	300 4T	1300	1100	1000	750	-	-	-
	350 4T	2500	2300	2000	1700	1400	-	-
	400 4T	3750	3300	3000	2300	1650	-	-
	450 4T	5250	4800	4200	3750	2100	-	-

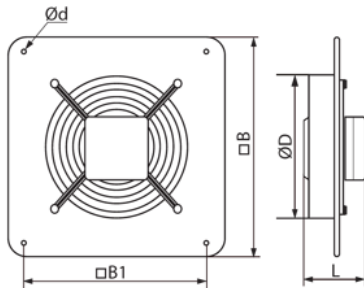

Dimensions

		OD [mm]	Od [mm]	B [mm]	B1 [mm]	L [mm]	kg
Mk.	200 2M	210	7	312	260	145	3
	250 2M	260	7	370	320	155	4
	250 2T	260	7	370	320	155	4
	250 4M	260	7	370	320	155	3.50
	250 4T	260	7	370	320	155	6.10
	300 2M	326	9	430	380	195	5.40
	300 2T	326	9	430	380	155	5
	300 4M	326	9	430	380	195	5.40
	300 4T	326	9	430	380	155	5
	350 4M	388	9	485	435	200	7.80
	350 4T	388	9	485	435	200	7.80
	400 4M	417	9	540	490	240	8.80
	400 4T	417	9	540	490	240	8.80
	450 4M	465	11	576	535	250	10.50
	450 4T	465	11	476	535	250	10.50
	500 4M	520	11	655	615	260	14
	550 4M	570	11	725	675	280	16.50
	550 4T	580	11	725	675	260	16.50
630 4M	650	11	800	710	295	20	
630 6M	650	11	800	710	295	20	